

## \$799,000 - Rr241 Twp 585, Rural Westlock County

MLS® #E4398231

**\$799,000**

0 Bedroom, 0.00 Bathroom,  
Rural on 160.00 Acres

None, Rural Westlock County, AB

Great opportunity to own a quarter section of farm land in Westlock county. This property has two 80 acre parcels (separate titles) currently in pasture land for Cattle. Property is fenced and is currently grazing cattle. Excellent opportunity for cereal crop land development into seed-able acres. Conveniently located close to pavement (Lily Lake Road).

### Essential Information

|           |                 |
|-----------|-----------------|
| MLS® #    | E4398231        |
| Price     | \$799,000       |
| Bathrooms | 0.00            |
| Acres     | 160.00          |
| Type      | Rural           |
| Sub-Type  | Vacant Lot/Land |
| Status    | Active          |

### Community Information

|             |                       |
|-------------|-----------------------|
| Address     | Rr241 Twp 585         |
| Area        | Rural Westlock County |
| Subdivision | None                  |
| City        | Rural Westlock County |
| County      | ALBERTA               |
| Province    | AB                    |
| Postal Code | T0G 1L2               |

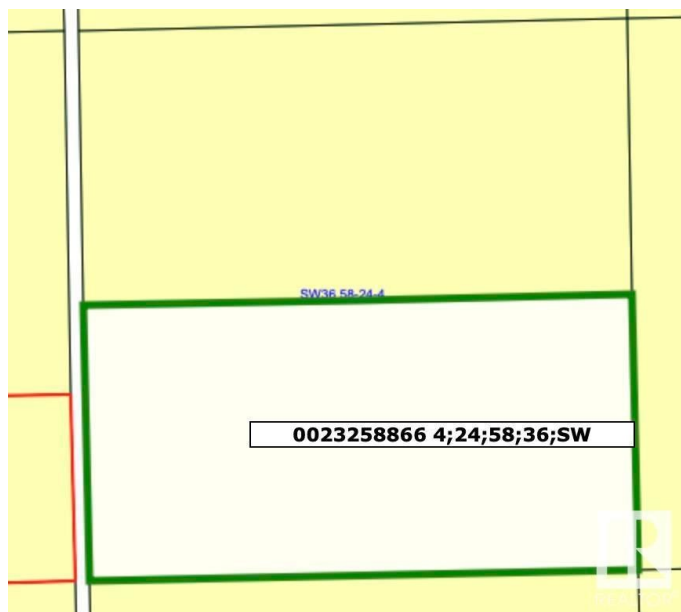

**Exterior**

Exterior Features    Fenced

**Additional Information**

Date Listed                July 18th, 2024  
Days on Market        335  
Zoning                      Zone 60

DATA IS DEEMED RELIABLE BUT IS NOT GUARANTEED ACCURATE BY THE REALTORS® ASSOCIATION OF EDMONTON. COPYRIGHT 2025 BY THE REALTORS® ASSOCIATION OF EDMONTON. ALL RIGHTS RESERVED.Trademarks are owned or controlled by the Canadian Real Estate Association (CREA) and identify real estate professionals who are members of CREA (REALTOR®, REALTORS®) and/or the quality of services they provide (MLS®, Multiple Listing Service®)  
Listing information last updated on June 18th, 2025 at 1:17pm MDT